



HanneBatLandskab

+45 7734 0770 hanne@batlandskab.dk
Stavrevej 512, 5300 Kerteminde

- 
- Paesaggi dell` anima e del corpo



*How do we make the
best conditions for our
society and everyday
life?*

A large, full-canopied oak tree stands in a grassy field. The tree is the central focus, with its dense green leaves filling most of the frame. The ground is a mix of green grass and some dry patches. In the background, there are other trees and a clear sky.

The old oak reminds us of the
short human life...

The rural landscapes as open fields and as a food resource is a part of our heritage and memory



A photograph of a lush green landscape. A path or road winds through a dense forest of tall, leafy trees. The foliage is vibrant green, and the path leads towards a bright, open area in the distance. The overall scene is peaceful and natural.

**The new rural paradigm:
The combination of agriculture,
tourism and landscape
conservation**

The need for areas to grow
tomatoes and herbs

The importance to see plants
develop from seed to fruit





The benefits of aesthetic surroundings remains as a crucial subject for further investigations...



Gardens, parks and landscape
planning can be seen as
landscape metaphores.

decadence ??
or
clever
civilization ??



A low-angle photograph of a tree with pink blossoms against a clear blue sky. The tree's branches are dark and silhouetted against the sky, with clusters of light pink flowers in bloom. The text is overlaid in white, sans-serif font, centered on the image.

Green spaces for:
nature elements
social interaktion
stimulation of the senses
sport
learning from nature
ecosystem
healing from stress

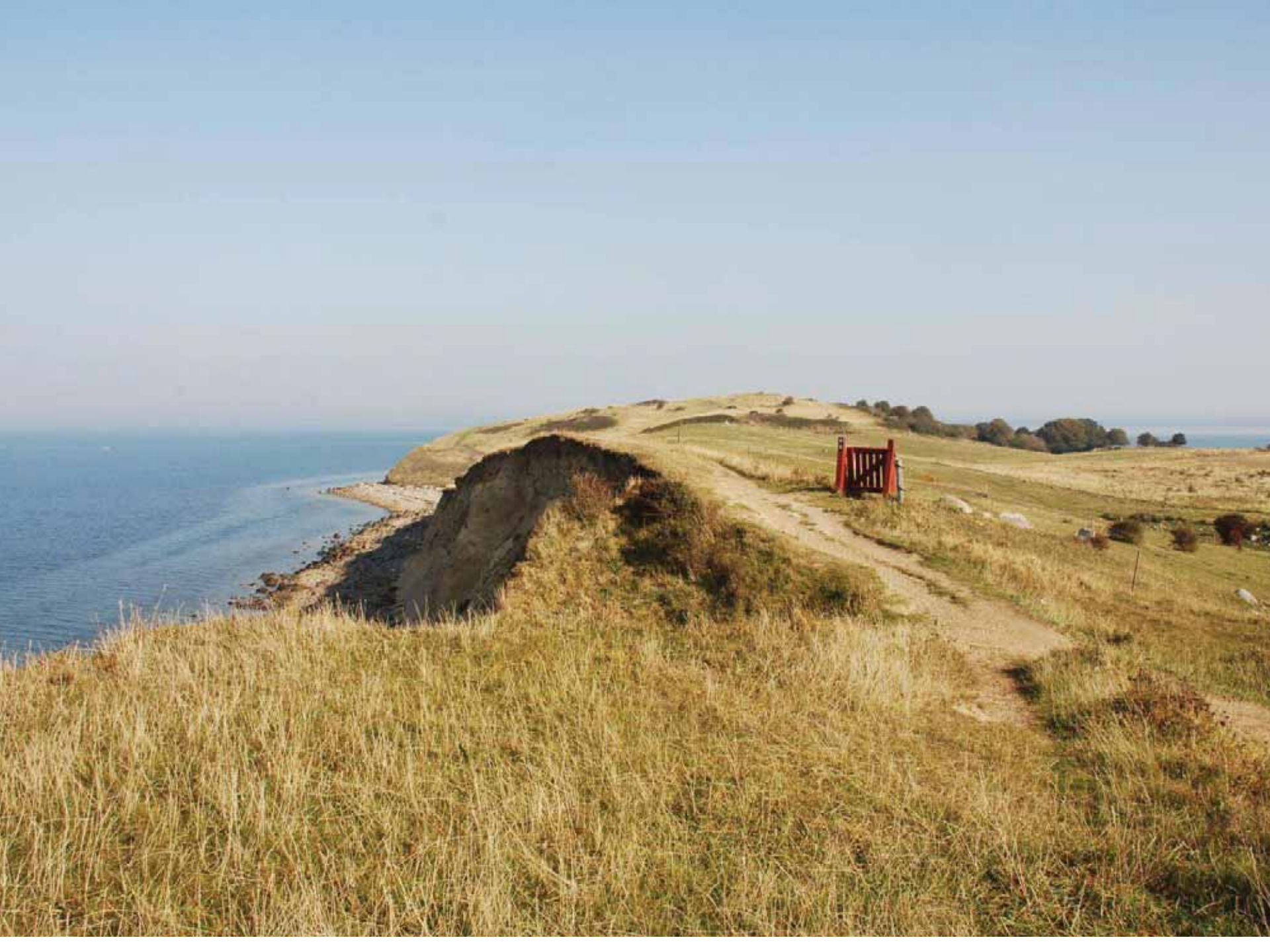



Hide ways for deers and humans..

islands without cars and consumption..

Maybe the new trend?



A landscape photograph showing a rolling hill under a hazy, golden sky, likely during sunrise or sunset. The foreground is dominated by dark, silhouetted foliage on the left and right sides. The central part of the image shows a grassy hillside that curves gently to the right. The sky is filled with soft, horizontal clouds, and the sun is visible as a bright, glowing orb on the right side of the horizon. The overall mood is serene and contemplative.

Phenomenons...
Nature is a never ending
process...

Seasons



Learning from nature in the development of the city-life







The multifunctional city life

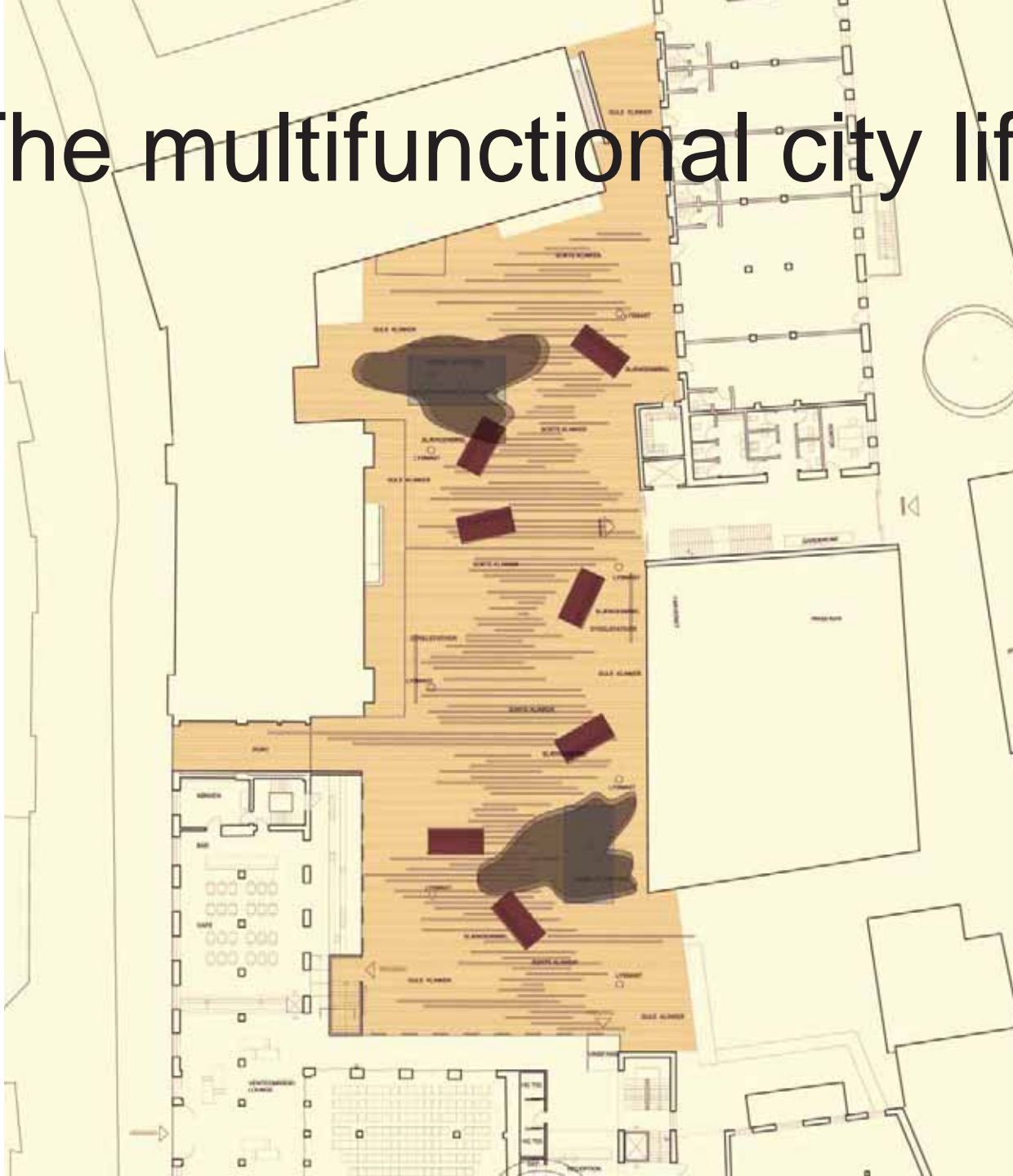

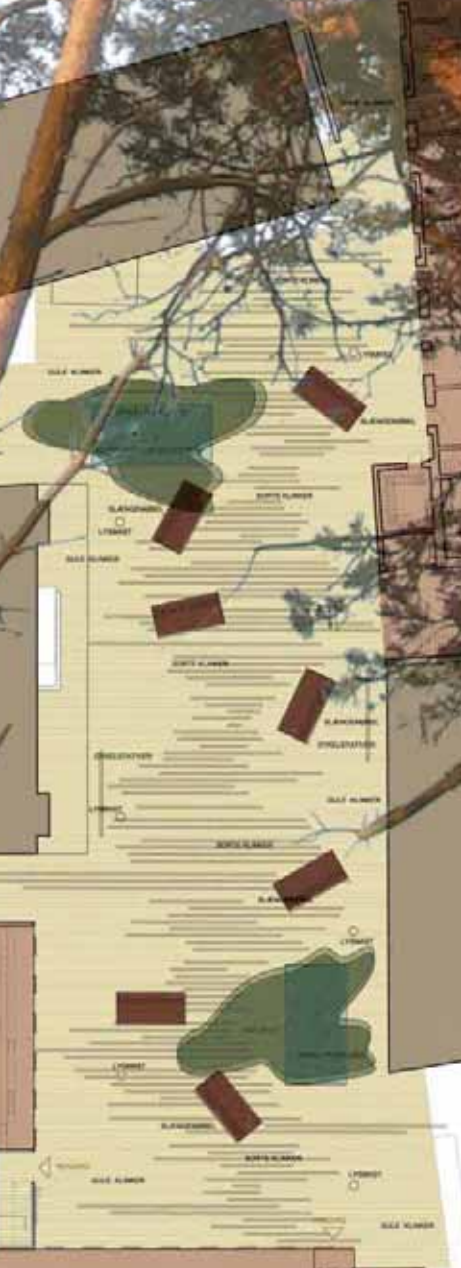

LANDSCAPE
LAYOUT

LANDSCAPE
LAYOUT

LANDSCAPE
LAYOUT

LANDSCAPE
LAYOUT

LANDSCAPE
LAYOUT

LANDSCAPE
LAYOUT

LANDSCAPE
LAYOUT

LANDSCAPE
LAYOUT

LANDSCAPE
LAYOUT

LANDSCAPE
LAYOUT

LANDSCAPE
LAYOUT

LANDSCAPE
LAYOUT

LANDSCAPE
LAYOUT

LANDSCAPE
LAYOUT

LANDSCAPE
LAYOUT

LANDSCAPE
LAYOUT

LANDSCAPE
LAYOUT

LANDSCAPE
LAYOUT

LANDSCAPE
LAYOUT

LANDSCAPE
LAYOUT

LANDSCAPE
LAYOUT

LANDSCAPE
LAYOUT

LANDSCAPE
LAYOUT

LANDSCAPE
LAYOUT

LANDSCAPE
LAYOUT

LANDSCAPE
LAYOUT

LANDSCAPE
LAYOUT



A photograph of a city plaza. In the foreground, there is a paved area with several low, rectangular concrete planters. Two trees with green foliage are planted in these planters. In the background, a white building with signs is visible. The signs include "KULTURMASKI EN" with a blue arrow pointing right, and "← MAGASIN T" with a pink circle. Several bicycles are parked in racks near the building. The text "Strong nature elements in the city life is needed" is overlaid in white on the image.

Strong nature elements in the
city life is needed











KULTURMASKINEN →
← MAGASINET





No money for renewal...



But the need for green spaces
in the city





And urgent need for bicycle parking!!

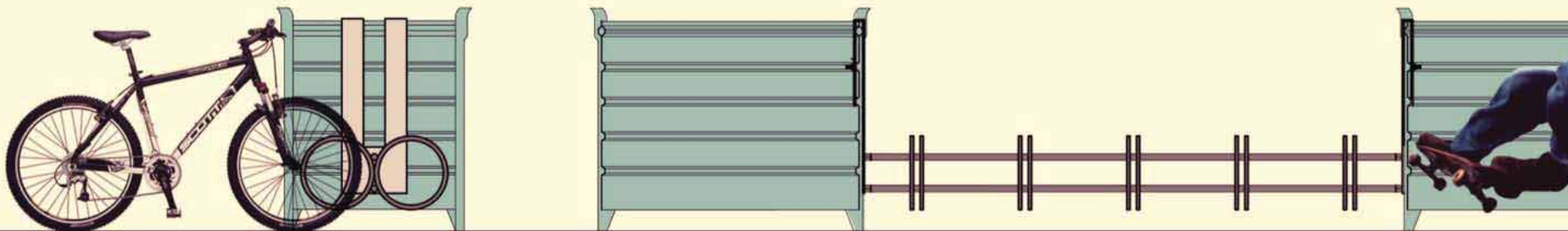

A photograph of a park area. In the foreground, there are several teal-colored planters arranged in a row. The planters are filled with green foliage. The ground is paved with a light-colored concrete path that curves to the right. In the background, there are residential buildings, trees, and a person riding a motorcycle. A white tent is visible on the right side of the image.

Contemporary concepts

the "hot-pot"

Local identity



Focus on the color...



350 hot-pots

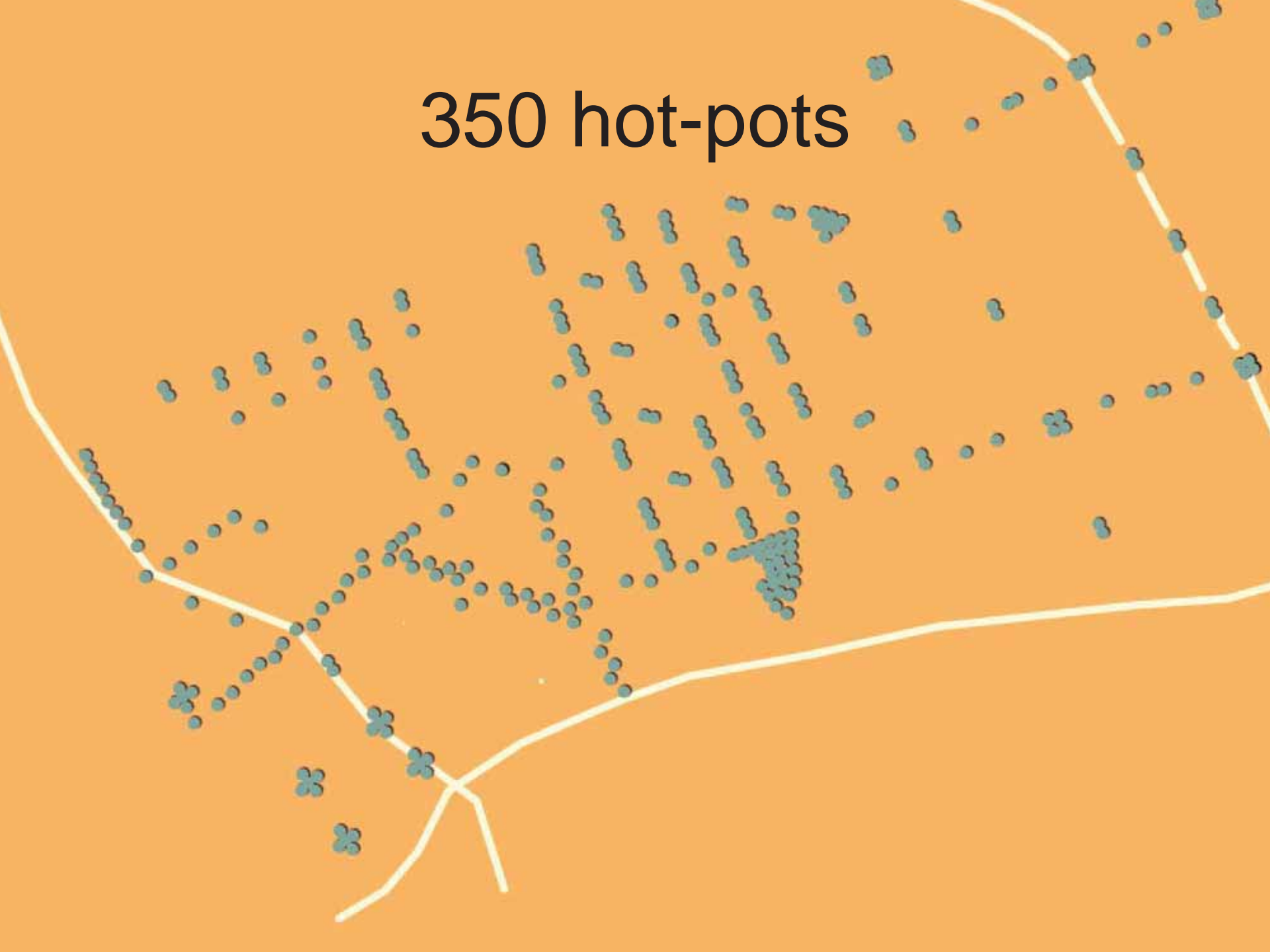

interaction

gifler i geisler



Traffic calming





AMELANCHIER LAEVIS BÆRMISPEL	PRUNUS LAUROCERASUS KIRSEBÆERLAURBÆER	CERCIS JUDASTRÆ	BETULA POPYRIFERA PAPIR-BIRK	PINUS CONTORTA KLIT-FYR	AILANTHUS ALTISSIMA SKYRÆKKER
PEROVSKIA ATRIPLICIFOLIA	HYPERICUM ERECTUM PERIKON	MESPILUS GERMANICA MISPEL	BUDDLEIA DAVIDII SOMMERFUGLEBUSK	CARAGANA ARBORESCENS SIBIRISK ÆRTETRÆ	HIBISCUS SYRIACUS SYRISK ROSE
ARMERIA MARITIMA ENGELSK GRÆS	ARONIA MELANOCARPA SURBÆER	MISCANTHUS SINENSIS ELEFANTGRÆS	STACHUS BYZANTINA LAMMEØR	NEPETA X FASSENII BLÅKANT	VINCA MINOR SINGRØN



involvement of citizens



Tango









FR551 F20

001

350 HOT POTS

A photograph of a park area. The foreground is dominated by tall, green grass. In the middle ground, there are several large, leafy trees. In the background, there are buildings and a street with parked cars. The sky is clear and blue.

The acceptance of more
"wilderness" in the parks

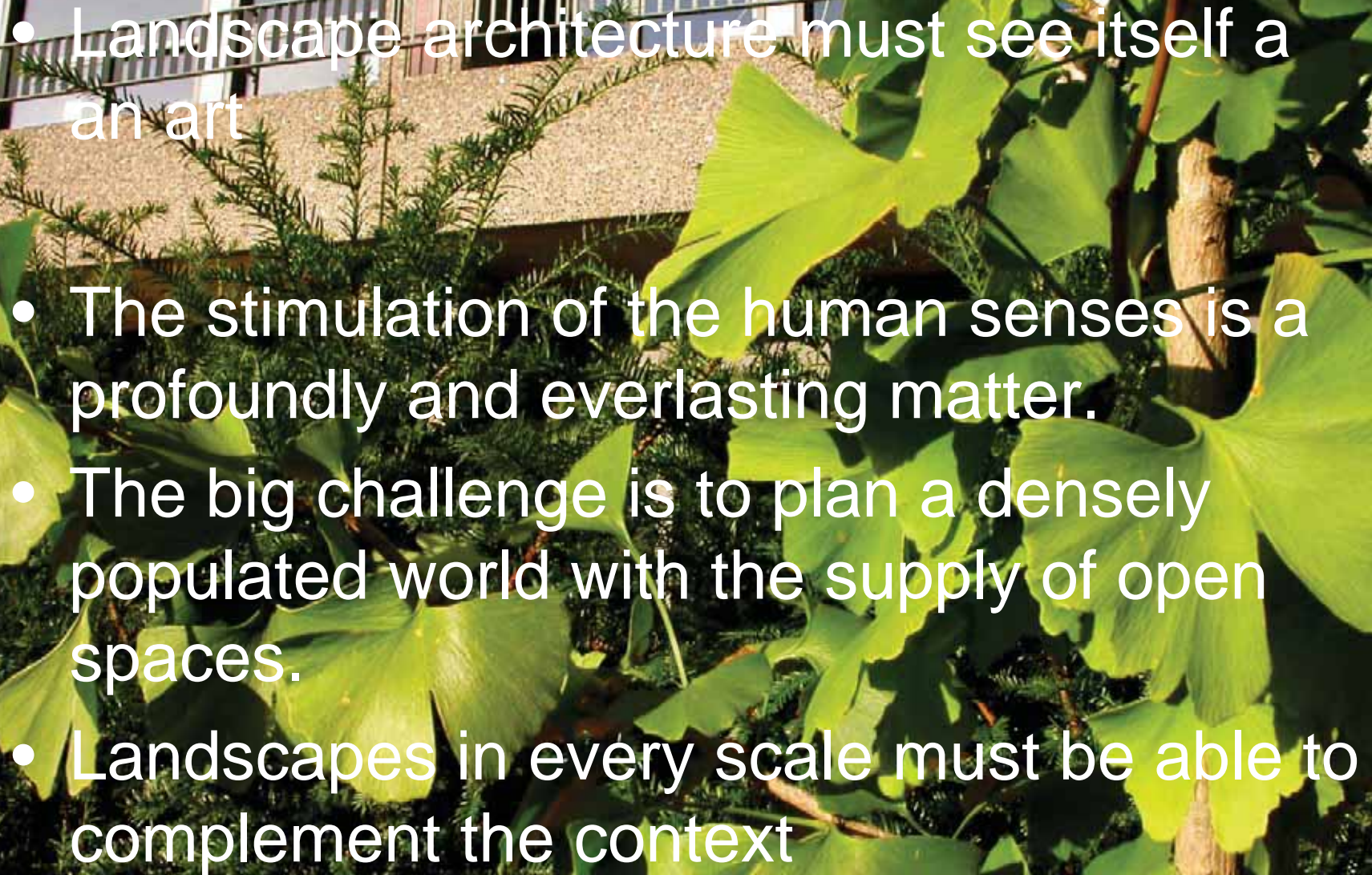

Space for irrational feelings is
needed

- 
- A photograph of a building with a balcony and a large ginkgo tree in the foreground. The building has a balcony with a metal railing and a textured wall. The ginkgo tree has large, fan-shaped leaves that are bright green. The text is overlaid on the image in white.
- Landscape architecture must see itself as an art
 - The stimulation of the human senses is a profoundly and everlasting matter.
 - The big challenge is to plan a densely populated world with the supply of open spaces.
 - Landscapes in every scale must be able to complement the context

Landscape as identity for planning



The transformation of industrial harbour into a living room



Using plants of



A photograph of a modern building with large windows and a landscaped area. The building has a white facade and brown window frames. The windows are partially covered with brown horizontal blinds. In the foreground, there is a paved area with a stone path and a raised bed of tall, golden-brown grasses. The text "Cars in the basement = 50 cm of soil for plants" is overlaid on the image.

Cars in the basement = 50 cm
of soil for plants







Spaces for activity

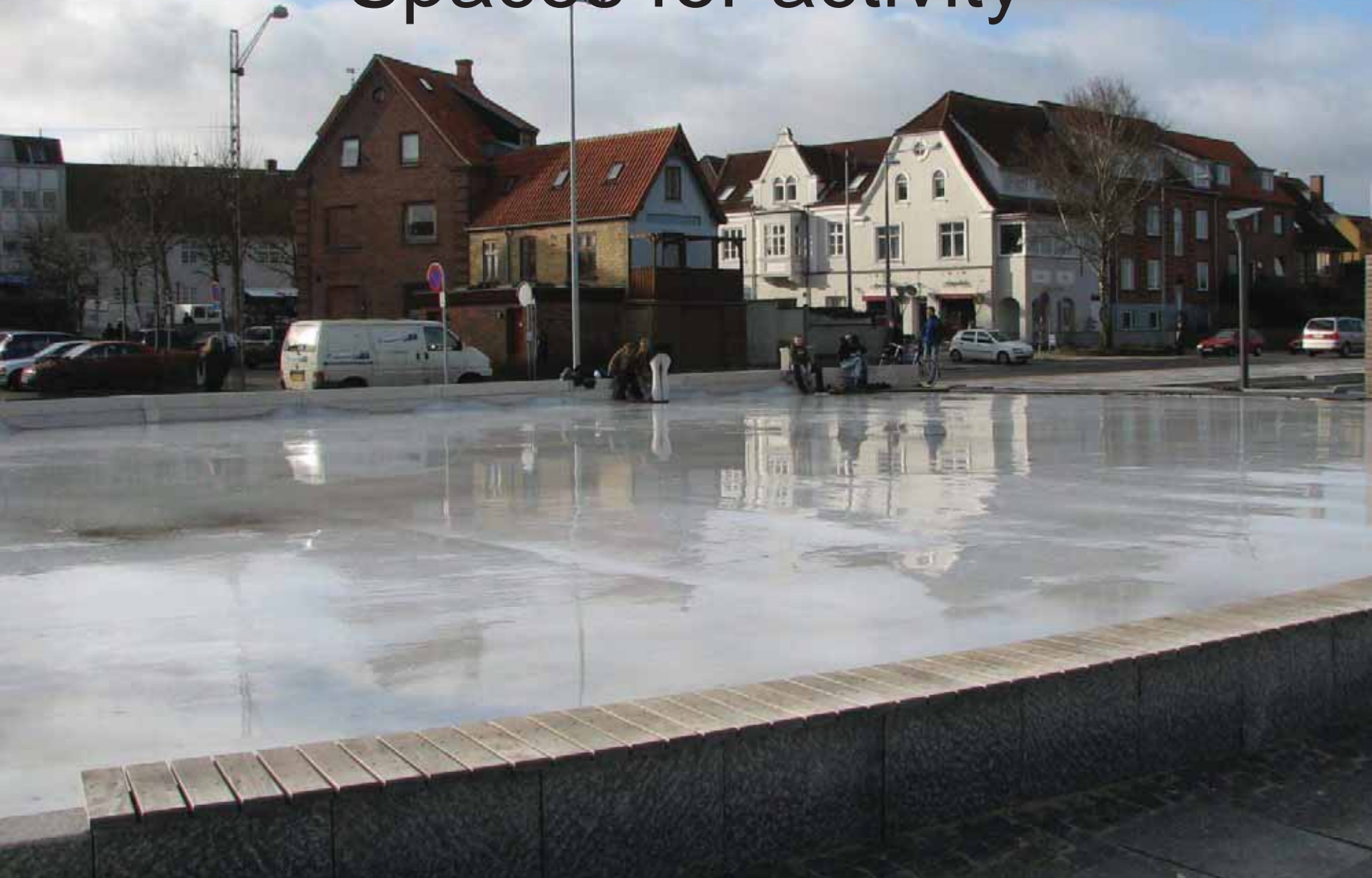







The waves of grass





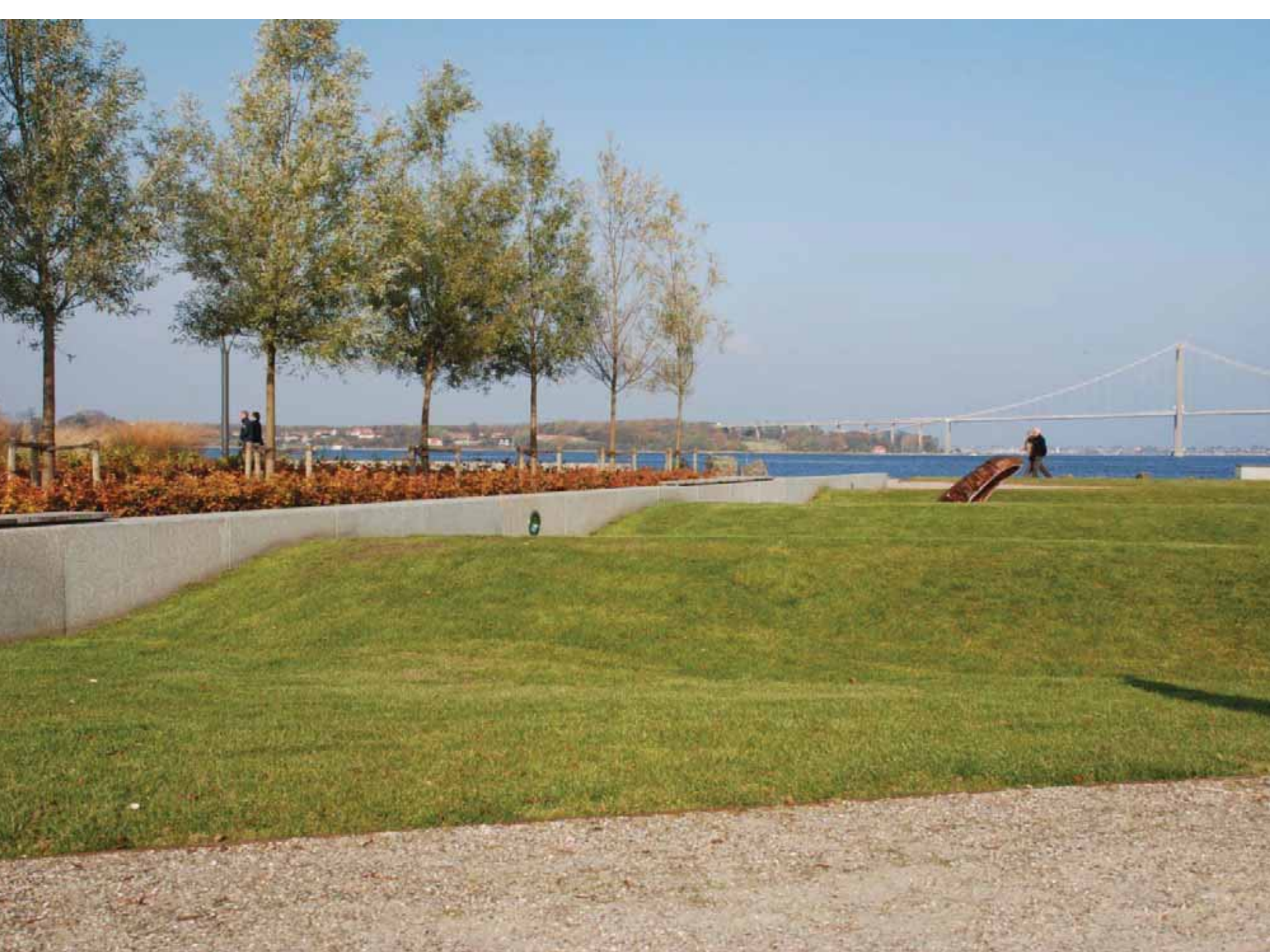

A photograph of a park with a winding path, a large tree in the foreground, and a fountain in the background. The text is overlaid on the image.

Parks and green spaces
reminds us of the things in life,
that are more important than
consumption

Important to value landscapes as a
human fundament



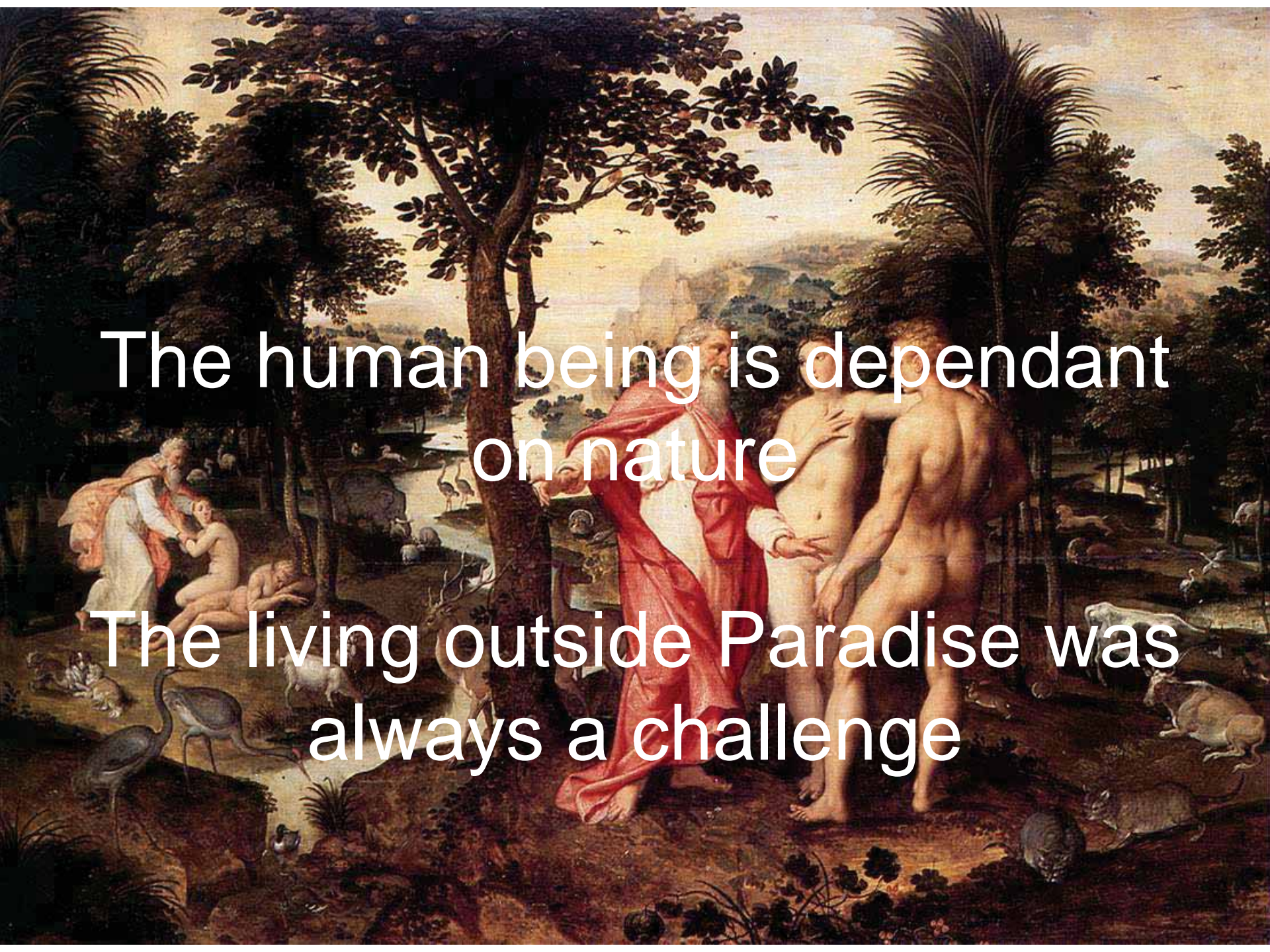

The human being is dependant
on nature

The living outside Paradise was
always a challenge

- We have to keep on reminding our selves of the values of parks and open landscapes!

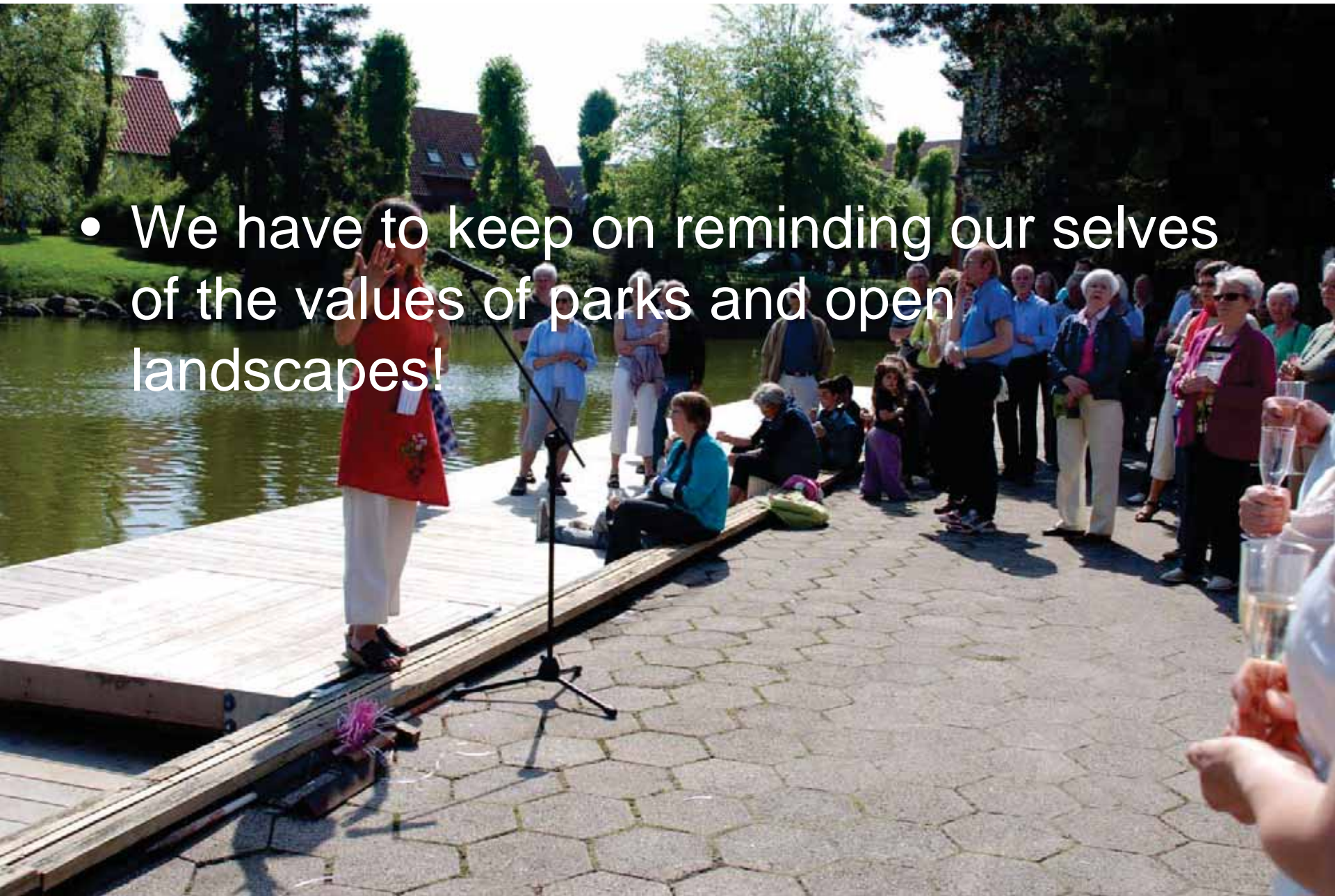

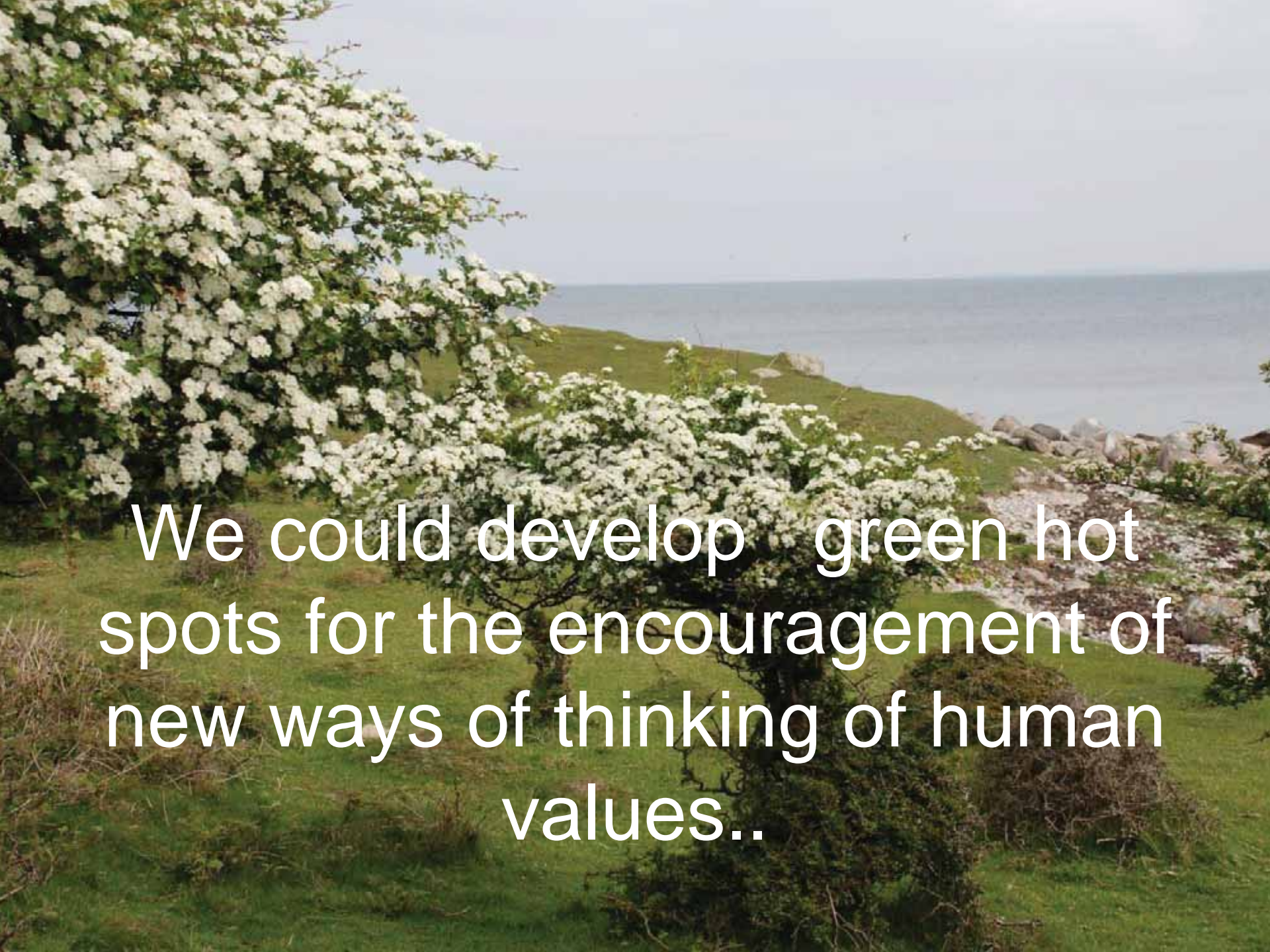
A scenic view of a green hillside overlooking the ocean. In the foreground, a large tree is covered in white blossoms. The text is overlaid on the image.

We could develop green hot spots for the encouragement of new ways of thinking of human values..